

Synthesis Fast-Mag

features & benefits

- Quick graphic change out
- Low voltage CCFL lighting
- Even lighting with no hot spots or shadows

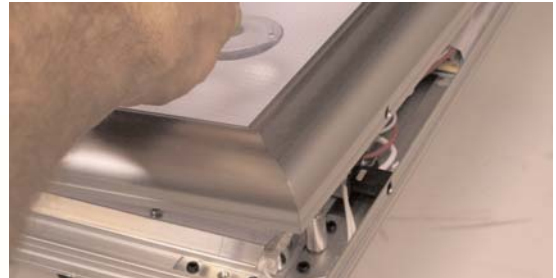

hardware specifications

additional info

Unit External dimensions:	Overall Graphics	Visual Graphic	Graphic material	Shipping Dimensions
SYNTH-FM-1 13.875" x 10.5" x 1.125"	SYNTH-FM-1 11.375" x 8"	SYNTH-FM-1 10.875" x 7.5"	UV resistant translucent film with over lam	SYNTH-FM-1 17.5" x 12" x 2.75"
SYNTH-FM-2 19" x 13.875" x 1.125"	SYNTH-FM-2 16.25" x 11.5"	SYNTH-FM-2 15.625" x 10.875"		SYNTH-FM-2 22.5" x 15.375" x 2.75"
SYNTH-FM-3 25.625" x 18.5" x 1.125"	SYNTH-FM-3 23.125" x 16.25"	SYNTH-FM-3 22.6" x 15.75"		SYNTH-FM-3 29.75" x 20.25" x 3"
SYNTH-FM-4 35.25" x 25.625" x 1.125"	SYNTH-FM-4 32.75" x 23.25"	SYNTH-FM-4 32.25" x 22.5"		SYNTH-FM-4 39.375" x 27" x 3.375"

We are continually improving and modifying our product range and reserve the right to vary the specifications without prior notice. All dimensions and weights quoted are approximate and we accept no responsibility for variance.

Assembly Instructions



1 Remove unit from carton. Use the suction cup that is found packaged with the transformer to remove the front faceplate

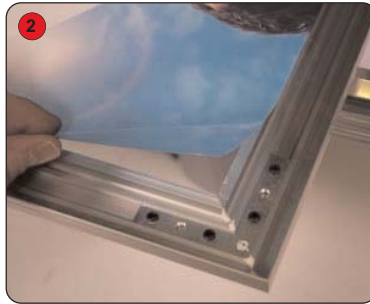

2 Place the face plate on a flat surface with the in side facing up. Remove the brown protective paper from the double face tape. Apply graphic face down to the double faced tape



3 Reattached the front face plate to the unit.



4 Your light box is now ready to be installed.



5 The hanging hardware on the back of the unit can be repositioned to allow for the unit to be vertically displayed. Loosen screw move hardware and tighten screw.



6 The units have two plug in options. One back mounted and one side mounted plug. This allows for the power cord to be concealed when the display is permanently installed. Plug the lightbox in after the display has been installed.

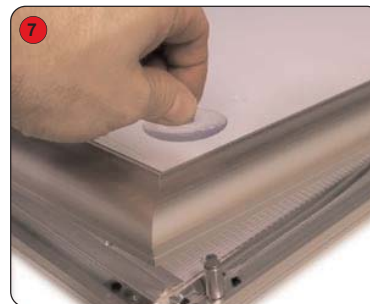

NOTE:

As with all electrical devices care must be taken when opening the lightbox.

Unplug the lightbox from the power cord before removing the front face plate.